

# NORTH ATLAS

COMMERCIAL REAL ESTATE

## Office For Lease

500 PORTAGE AVENUE  
WINNIPEG, MB

### North Atlas Commercial Real Estate

1201 - 191 Lombard Avenue  
Winnipeg, MB, R3B 0X1  
[www.NorthAtlas.ca](http://www.NorthAtlas.ca)

### Jonah Levine

Partner & Managing Broker  
204.918.1438 Mobile  
204.942.2400 Office  
[Jonah@NorthAtlas.ca](mailto:Jonah@NorthAtlas.ca)

### Khush Grewal

Partner  
204.891.1999 Mobile  
204.942.2400 Office  
[Khush@NorthAtlas.ca](mailto:Khush@NorthAtlas.ca)

## PROPERTY HIGHLIGHTS

OFFICE FOR LEASE | **500 PORTAGE AVENUE** | WINNIPEG, MB

There's an energetic feeling to 500 Portage Avenue, located in the shadow of the vibrant University of Winnipeg campus and all the its surrounding amenities. New investments in 2018 elevated the exterior, lobby, elevators and main floor amenities of this wonderful office building located just on the edge of downtown. Connected to a larger residential and retail complex, as well as the wider neighbourhood, 500 Portage offers business owners and staff convenience and prestige. Retail amenities on site include a convenience store, sushi restaurant, pizza place, bubble tea shop, medical clinic, and barbershop. Parking is available on site and underground, and some of the best bus connections in Winnipeg are located right outside the front door.

As a future office tenant at 500 Portage, you'll enjoy:



Convenience of proximity to every amenity downtown, in Osborne Village, in St. Boniface, on Academy Road AND in the Polo Park shopping district inside of a 7 minute drive, all without having to experience the worst of downtown rush hour.



The vibrancy and energy outside your front door that can only be found around an urban university campus.



Professional on site 24/7 maintenance and the operational expertise of a major Canadian property manager.



### North Atlas Commercial Real Estate

1201 - 191 Lombard Avenue  
Winnipeg, MB, R3B 0X1  
[www.NorthAtlas.ca](http://www.NorthAtlas.ca)

### Jonah Levine

Partner & Managing Broker  
204.918.1438 Mobile  
204.942.2400 Office  
[Jonah@NorthAtlas.ca](mailto:Jonah@NorthAtlas.ca)

### Khush Grewal

Partner  
204.891.1999 Mobile  
204.942.2400 Office  
[Khush@NorthAtlas.ca](mailto:Khush@NorthAtlas.ca)

# NORTH ATLAS

COMMERCIAL REAL ESTATE

## VIBRANT SURROUNDINGS

OFFICE FOR LEASE | **500 PORTAGE AVENUE** | WINNIPEG, MB

Thanks to proximity to the University of Winnipeg and many other important downtown anchors, you'll find fantastic amenities steps away that fit all lifestyles, and a comfortable energetic urban environment that is hard to replicate.

THE  
GOOD  
WILL



STELLA'S

SUSHIGEN

wag



### North Atlas Commercial Real Estate

1201 - 191 Lombard Avenue  
Winnipeg, MB, R3B 0X1  
[www.NorthAtlas.ca](http://www.NorthAtlas.ca)

### Jonah Levine

Partner & Managing Broker  
204.918.1438 Mobile  
204.942.2400 Office  
[Jonah@NorthAtlas.ca](mailto:Jonah@NorthAtlas.ca)

### Khush Grewal

Partner  
204.891.1999 Mobile  
204.942.2400 Office  
[Khush@NorthAtlas.ca](mailto:Khush@NorthAtlas.ca)

## PROPERTY DETAILS

OFFICE FOR LEASE | **500 PORTAGE AVENUE** | WINNIPEG, MB

**Net Rental Rate:** \$13.50 per square foot

**Additional Rent:** \$13.50 per square foot  
(2022 Estimated)

- 24/7 On Site Maintenance
- Underground and surface parking available (4 stalls per 1000 SF)
- Building Signage Opportunity
- Brand new lobby, elevator cabs, and exterior finish

UNIT	SPACE AVAILABLE	
200	5,425 SF	} Can be combined <b>6,184 SF</b>
220	759 SF	
310	1,445 SF	
350	1,885 SF	
380	1,845 SF	Available Feb. 2023
400	10,514 SF	Full Floor
510	3,242 SF	} Can be combined <b>6,766 SF</b>
595	3,524 SF	
600	10,692 SF	Full Floor
720	1,733 SF	



**North Atlas Commercial Real Estate**  
1201 - 191 Lombard Avenue  
Winnipeg, MB, R3B 0X1  
www.NorthAtlas.ca

**Jonah Levine**  
Partner & Managing Broker  
204.918.1438 Mobile  
204.942.2400 Office  
Jonah@NorthAtlas.ca

**Khush Grewal**  
Partner  
204.891.1999 Mobile  
204.942.2400 Office  
Khush@NorthAtlas.ca

## SECOND FLOOR OPPORTUNITY

OFFICE FOR LEASE | **500 PORTAGE AVENUE** | WINNIPEG, MB

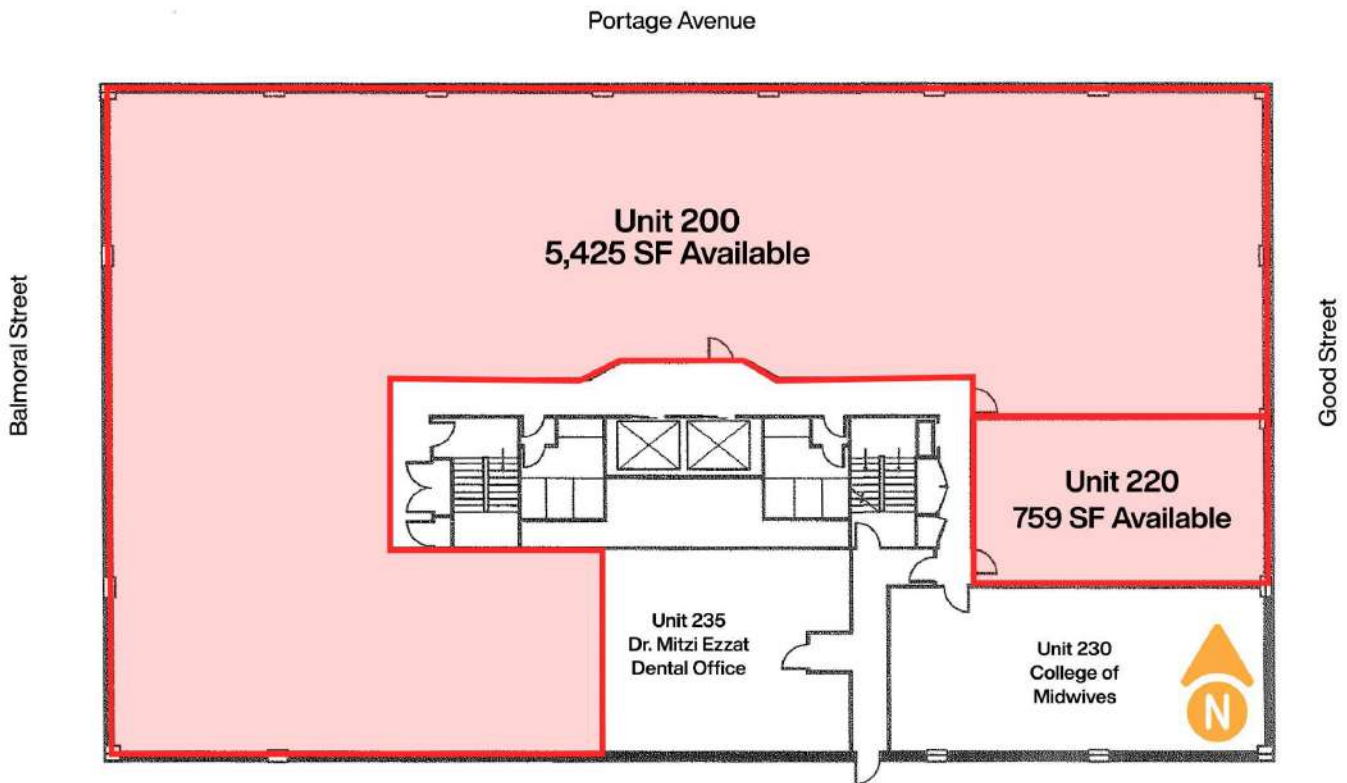

### North Atlas Commercial Real Estate

1201 - 191 Lombard Avenue  
Winnipeg, MB, R3B 0X1  
[www.NorthAtlas.ca](http://www.NorthAtlas.ca)

### Jonah Levine

Partner & Managing Broker  
204.918.1438 Mobile  
204.942.2400 Office  
[Jonah@NorthAtlas.ca](mailto:Jonah@NorthAtlas.ca)

### Khush Grewal

Partner  
204.891.1999 Mobile  
204.942.2400 Office  
[Khush@NorthAtlas.ca](mailto:Khush@NorthAtlas.ca)

## THIRD FLOOR OPPORTUNITY

OFFICE FOR LEASE | **500 PORTAGE AVENUE** | WINNIPEG, MB

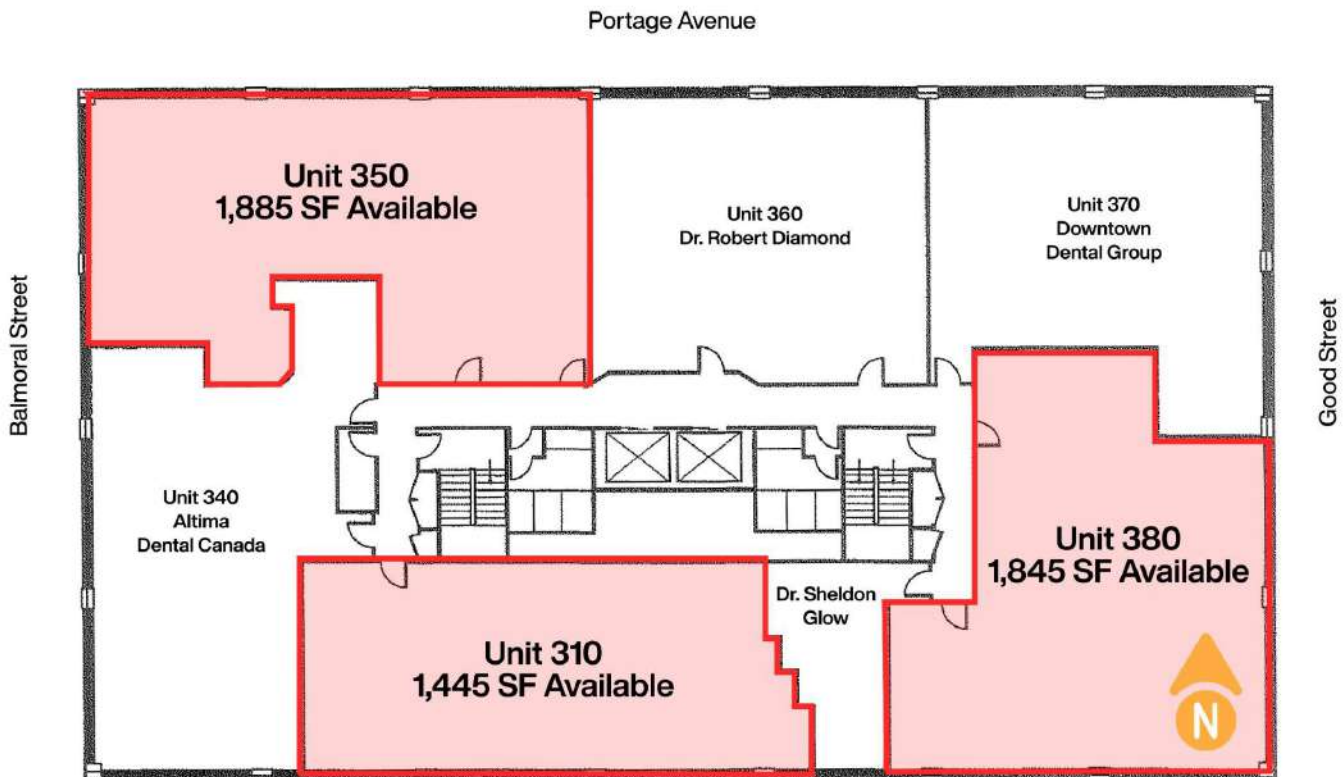

### North Atlas Commercial Real Estate

1201 - 191 Lombard Avenue  
Winnipeg, MB, R3B 0X1  
[www.NorthAtlas.ca](http://www.NorthAtlas.ca)

### Jonah Levine

Partner & Managing Broker  
204.918.1438 Mobile  
204.942.2400 Office  
[Jonah@NorthAtlas.ca](mailto:Jonah@NorthAtlas.ca)

### Khush Grewal

Partner  
204.891.1999 Mobile  
204.942.2400 Office  
[Khush@NorthAtlas.ca](mailto:Khush@NorthAtlas.ca)

## FOURTH FLOOR OPPORTUNITY

OFFICE FOR LEASE | **500 PORTAGE AVENUE** | WINNIPEG, MB

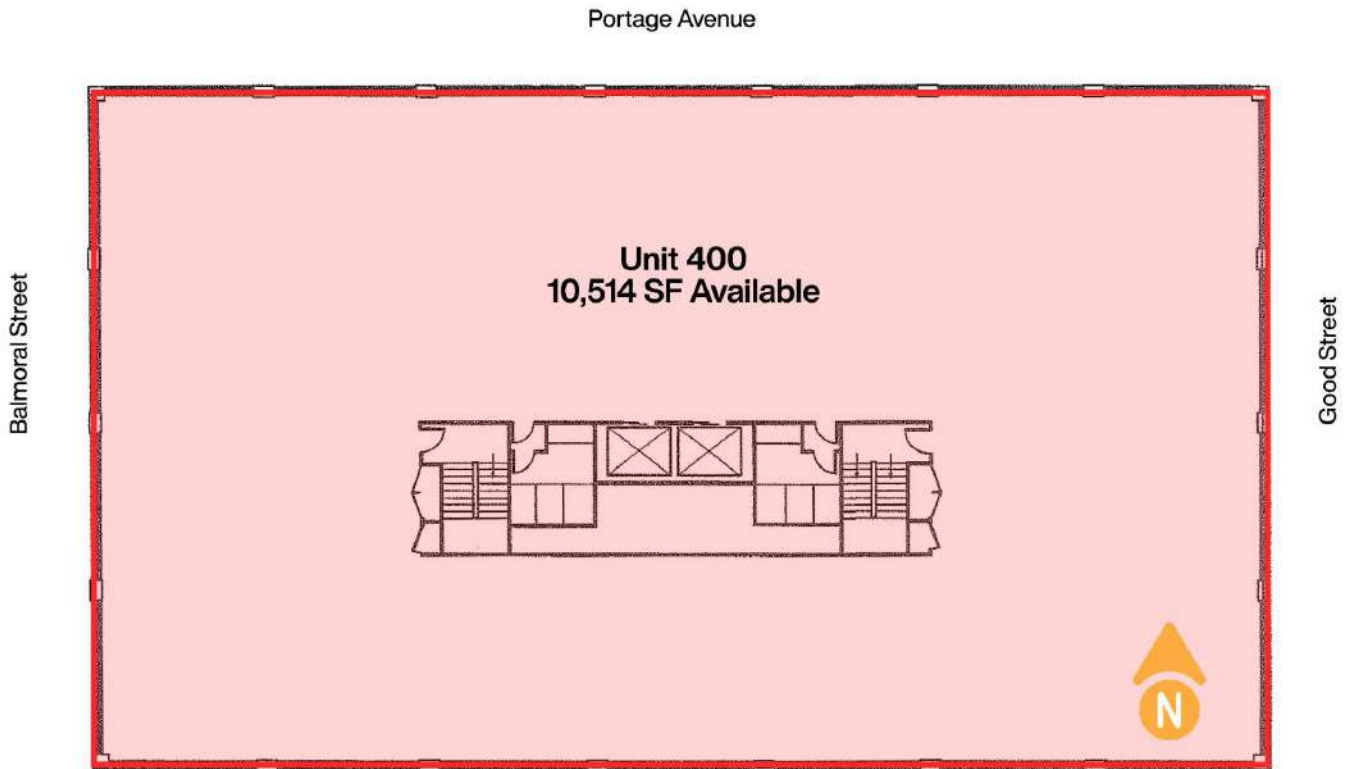

### North Atlas Commercial Real Estate

1201 - 191 Lombard Avenue  
Winnipeg, MB, R3B 0X1  
[www.NorthAtlas.ca](http://www.NorthAtlas.ca)

### Jonah Levine

Partner & Managing Broker  
204.918.1438 Mobile  
204.942.2400 Office  
[Jonah@NorthAtlas.ca](mailto:Jonah@NorthAtlas.ca)

### Khush Grewal

Partner  
204.891.1999 Mobile  
204.942.2400 Office  
[Khush@NorthAtlas.ca](mailto:Khush@NorthAtlas.ca)

## FIFTH FLOOR OPPORTUNITY

OFFICE FOR LEASE | **500 PORTAGE AVENUE** | WINNIPEG, MB

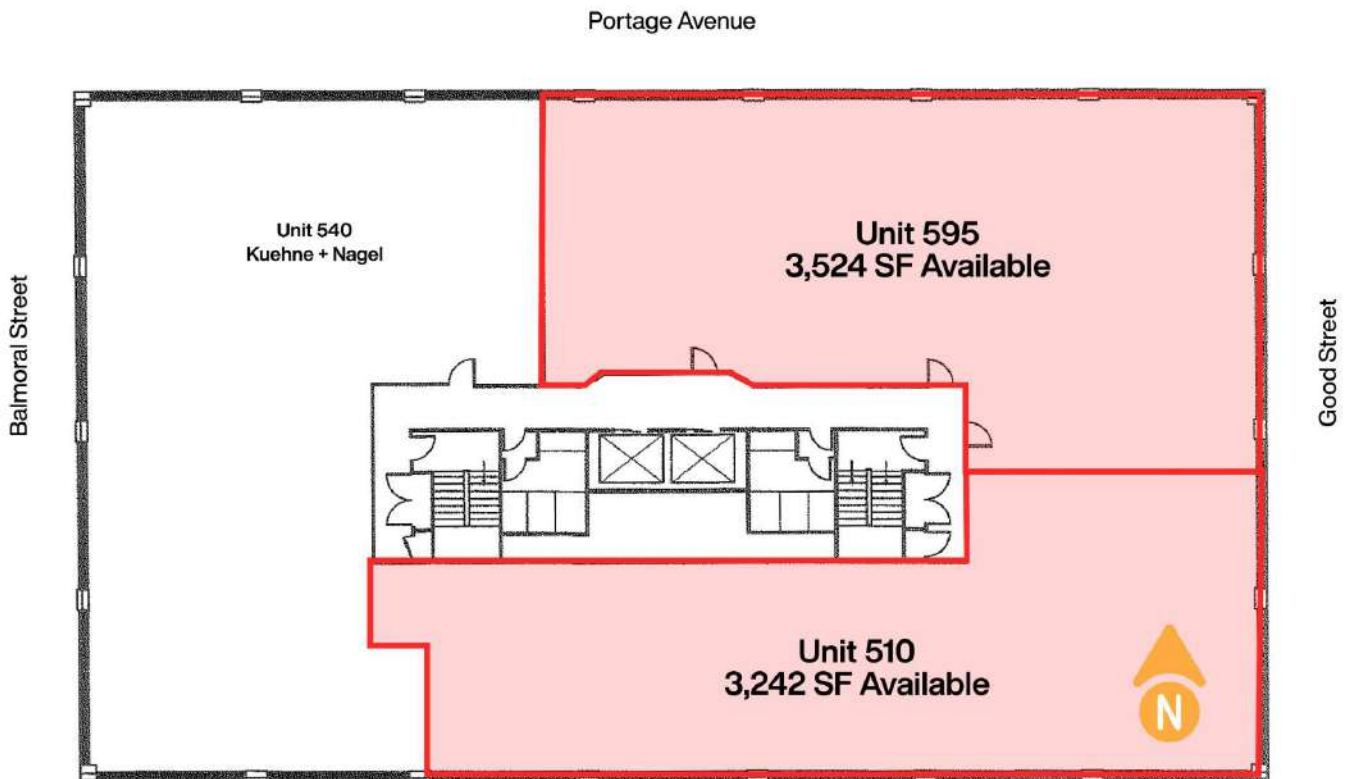

### North Atlas Commercial Real Estate

1201 - 191 Lombard Avenue  
Winnipeg, MB, R3B 0X1  
[www.NorthAtlas.ca](http://www.NorthAtlas.ca)

### Jonah Levine

Partner & Managing Broker  
204.918.1438 Mobile  
204.942.2400 Office  
[Jonah@NorthAtlas.ca](mailto:Jonah@NorthAtlas.ca)

### Khush Grewal

Partner  
204.891.1999 Mobile  
204.942.2400 Office  
[Khush@NorthAtlas.ca](mailto:Khush@NorthAtlas.ca)



# NORTH ATLAS

COMMERCIAL REAL ESTATE

## SIXTH FLOOR OPPORTUNITY

OFFICE FOR LEASE | **500 PORTAGE AVENUE** | WINNIPEG, MB

Portage Avenue

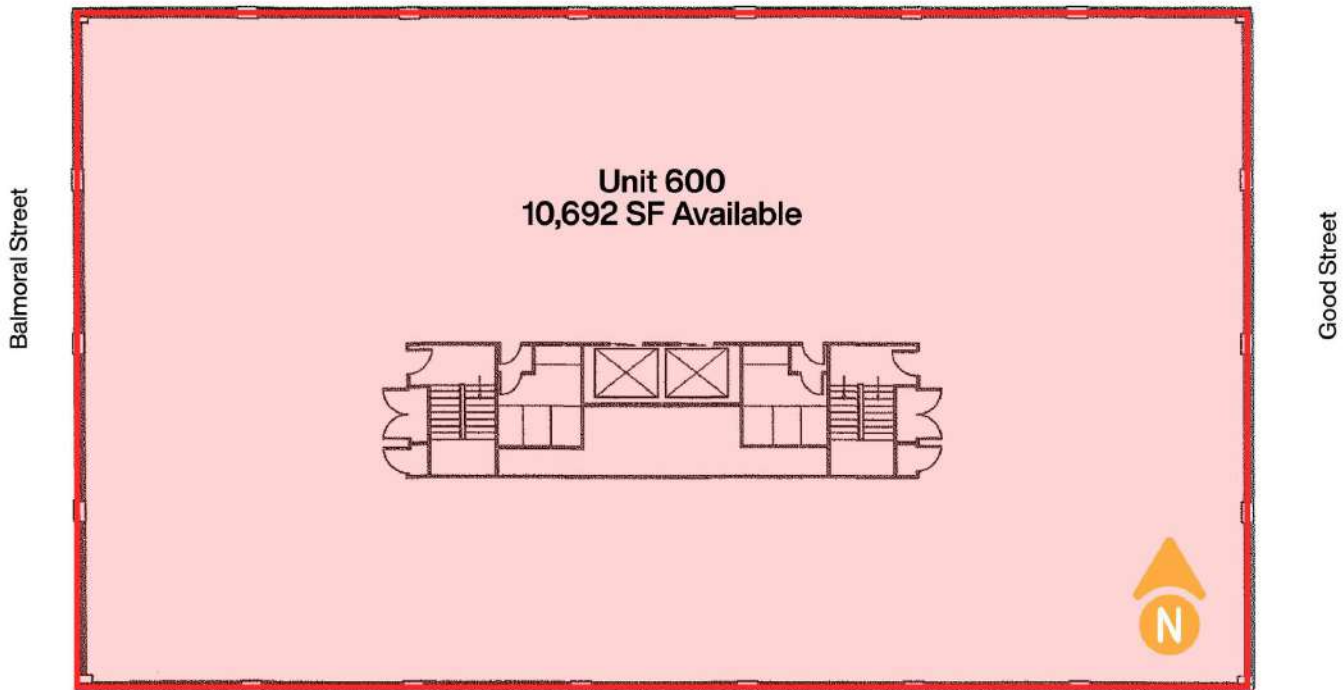

### North Atlas Commercial Real Estate

1201 - 191 Lombard Avenue  
Winnipeg, MB, R3B 0X1  
[www.NorthAtlas.ca](http://www.NorthAtlas.ca)

### Jonah Levine

Partner & Managing Broker  
204.918.1438 Mobile  
204.942.2400 Office  
[Jonah@NorthAtlas.ca](mailto:Jonah@NorthAtlas.ca)

### Khush Grewal

Partner  
204.891.1999 Mobile  
204.942.2400 Office  
[Khush@NorthAtlas.ca](mailto:Khush@NorthAtlas.ca)

## SEVENTH FLOOR OPPORTUNITY

OFFICE FOR LEASE | **500 PORTAGE AVENUE** | WINNIPEG, MB

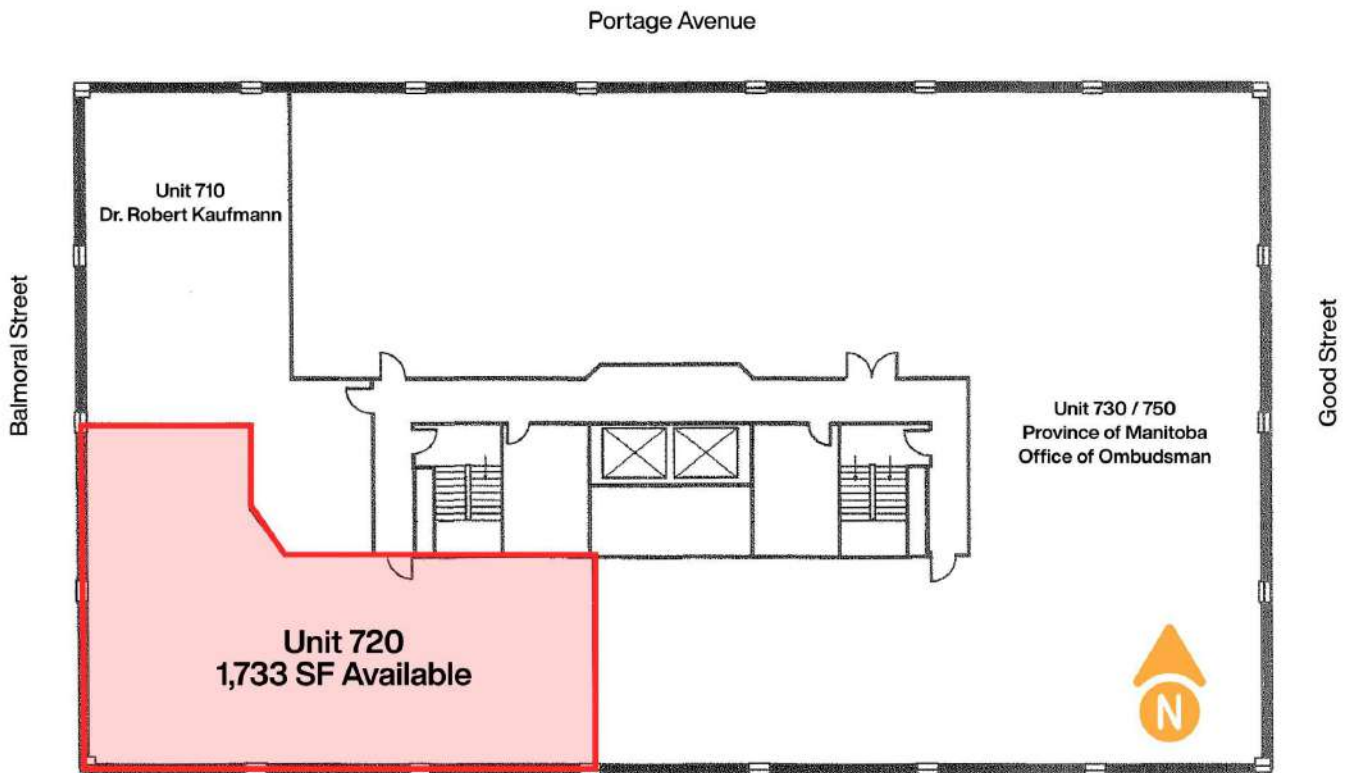

### North Atlas Commercial Real Estate

1201 - 191 Lombard Avenue  
Winnipeg, MB, R3B 0X1  
[www.NorthAtlas.ca](http://www.NorthAtlas.ca)

### Jonah Levine

Partner & Managing Broker  
204.918.1438 Mobile  
204.942.2400 Office  
[Jonah@NorthAtlas.ca](mailto:Jonah@NorthAtlas.ca)

### Khush Grewal

Partner  
204.891.1999 Mobile  
204.942.2400 Office  
[Khush@NorthAtlas.ca](mailto:Khush@NorthAtlas.ca)

# NORTH ATLAS

COMMERCIAL REAL ESTATE

## 500 PORTAGE AVENUE

OFFICE FOR LEASE | WINNIPEG, MB

CALL 204-942-2400 TO LEARN MORE!

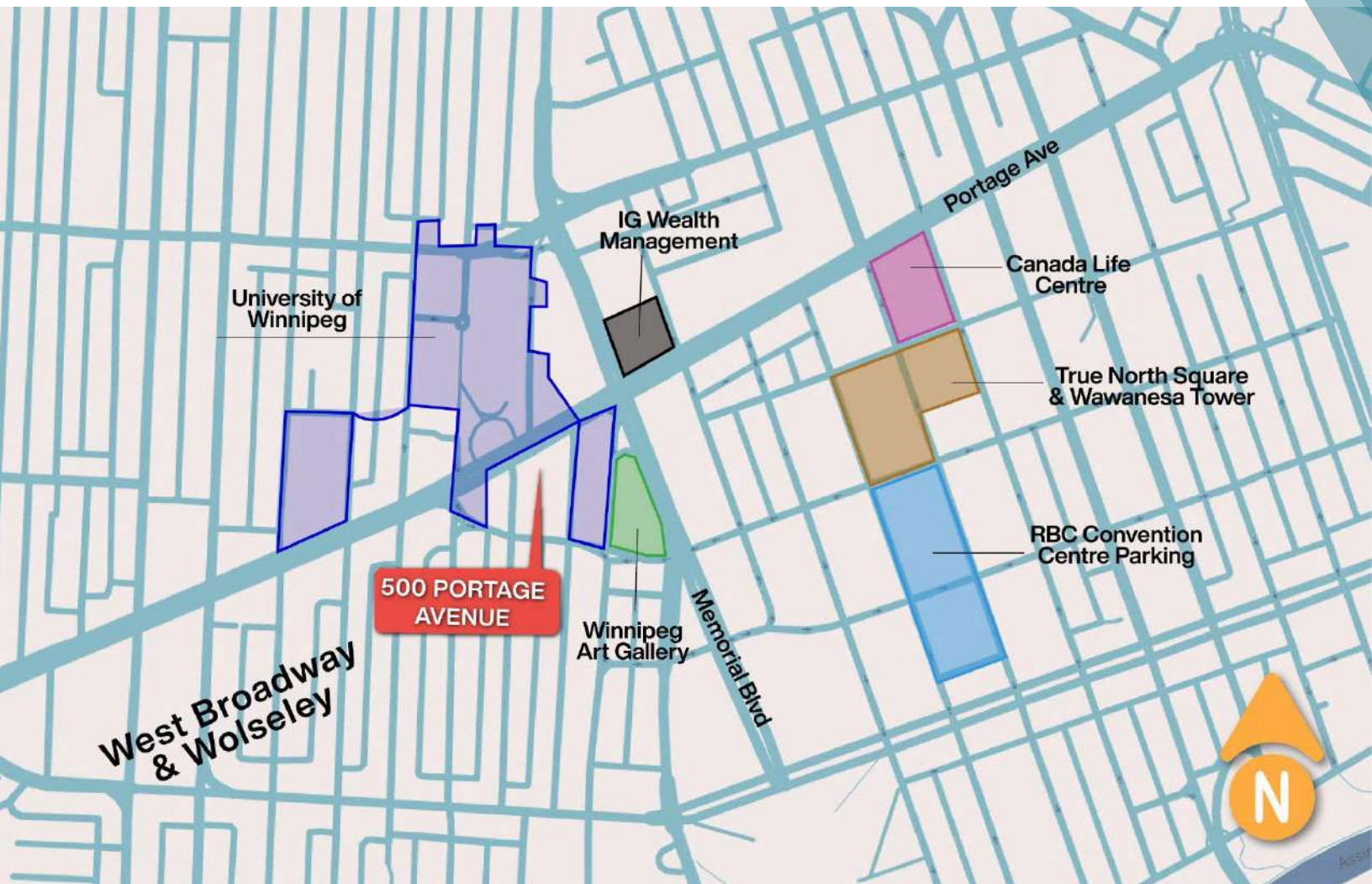

### North Atlas Commercial Real Estate

1201 - 191 Lombard Avenue  
Winnipeg, MB, R3B 0X1  
[www.NorthAtlas.ca](http://www.NorthAtlas.ca)

### Jonah Levine

Partner & Managing Broker  
204.918.1438 Mobile  
204.942.2400 Office  
[Jonah@NorthAtlas.ca](mailto:Jonah@NorthAtlas.ca)

### Khush Grewal

Partner  
204.891.1999 Mobile  
204.942.2400 Office  
[Khush@NorthAtlas.ca](mailto:Khush@NorthAtlas.ca)