

Industrial Space

150, Montreal-Toronto Blvd., Lachine, QC

Leasing Opportunity - Up to 482,600 s.f.



Property details

BUILDING AREA	891,098 s.f.	
AVAILABLE AREA	A : 38,400 s.f. B + C : 84,543 s.f.	E : 32,218 s.f. F : 78,300 s.f. G : 249,210 s.f.
LOADING DOCKS	A : TBD B + C : 2 truck level, 0 drive-in	E : 11 truck level, 2 drive-in F : 18 truck level, 1 drive-in G : 11 truck level, 0 drive-in
CLEAR HEIGHT	A : 15' B + C : 20' - 30'	E : 14' F : 20' - 30' G : 18' - 20'
COLUMN SPAN	A : 30' x 30' B + C : 30' x 60'	E : 30' x 30' F : 30' x 60' G : 30' x 30'
AVAILABILITY	A, B + C : Immediate E, F, G : TBD	
RENT	\$ 3.50	
OPERATING EXPENSES AND TAXES	\$ 2.06	
ELECTRICITY AND HEATING	\$ 1.25	

For information, please contact:

JEAN-MARC CHARLAND, ING
Vice President, Industrial Services
Real Estate Broker
jmcharland@asgaard.ca

T 514.729.8484
F 514.729.7450

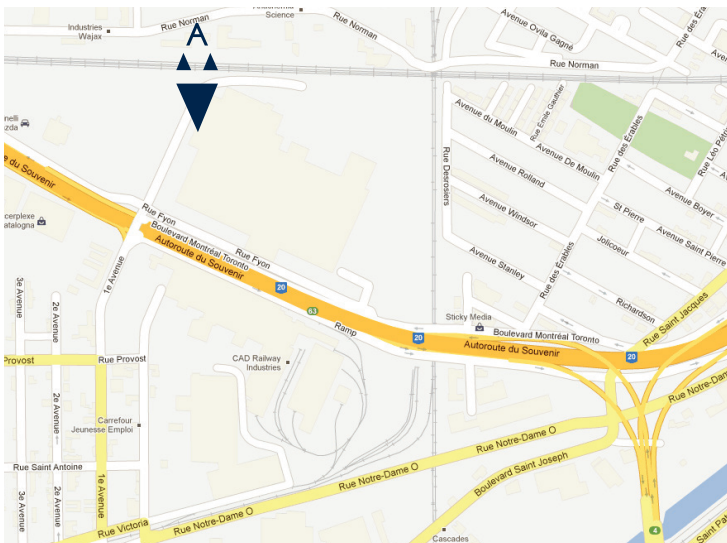
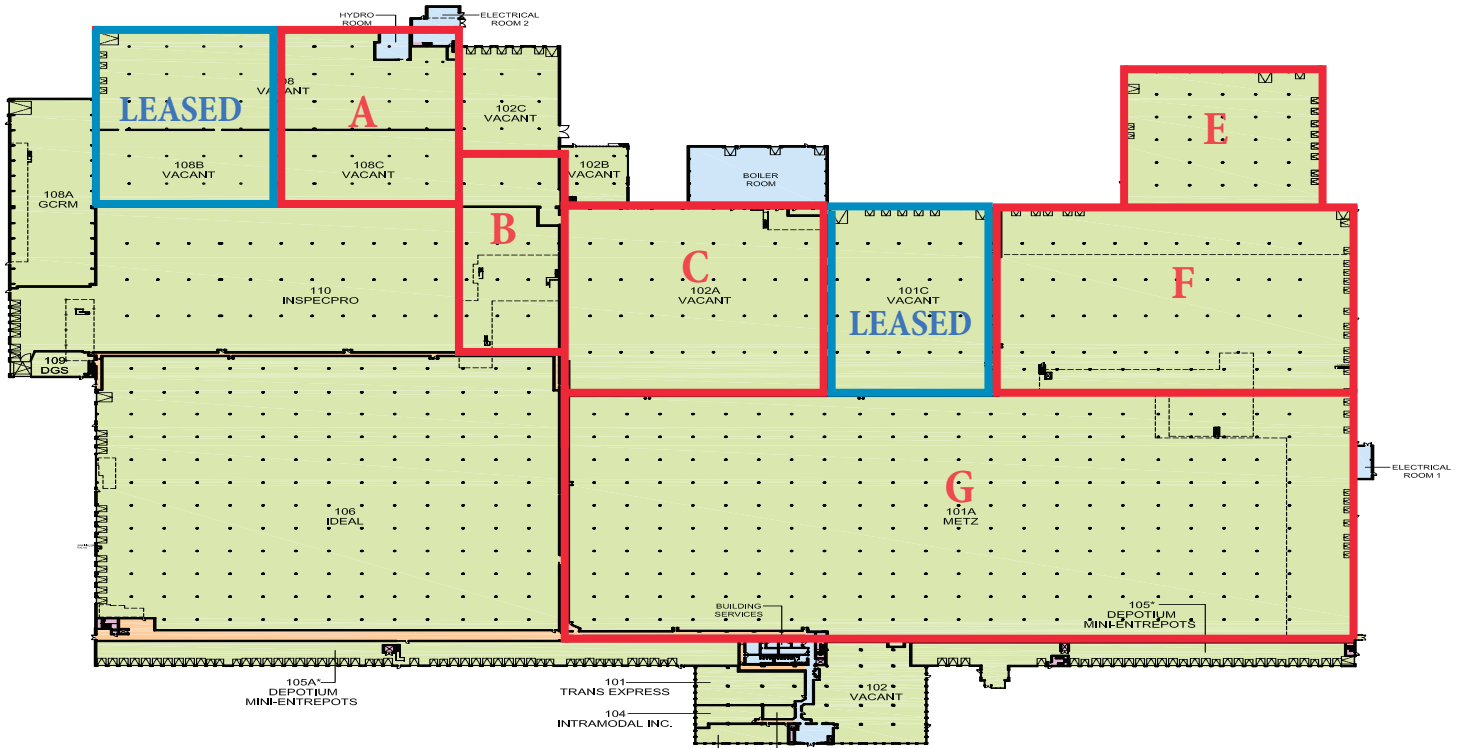

Property highlights

- Multi-tenant industrial property
- Great exposure along Highway 20
- Located near highways 20 and 13
- Large parking area
- Minutes away from Pierre-Elliott Trudeau airport
- Low operating cost and taxes

DISCLAIMER

© 2017 Asgaard Inc. All rights reserved. All information contained herein is from sources deemed reliable; however, no representation or warranty is made to the accuracy thereof. Services Immobiliers Asgaard Inc. Real Estate Agency