

# 1140 MORRISON DRIVE



## EXCELLENT LOCATION

Located just off Greenbank Road, 1140-1150 Morrison Drive provides an excellent opportunity to lease open and enclosed office space with an abundance of natural light, as well as providing on-site signage and parking. 1140-1150 Morrison Drive is located minutes from Highway 416 & 417 in a quiet and safe business neighbourhood with many amenities close by.



## HIGHLIGHTS

- › Professionally managed Class "B" office building
- › Rental Rate: \$12.00 (PSF)
- › Operating Cost: \$10.31 (PSF)
- › Close to amenities such as: Bridgehead, Big Rig, Chapters, Ikea, Milestones, Subway and Starbucks
- › Ample parking on site and close to public transit
- › Available immediately

## AVAILABLE SPACE

**SUITE 216**      2,540 SF

Six (6) enclosed office spaces, boardroom, kitchenette and server room.

# FLOOR PLAN

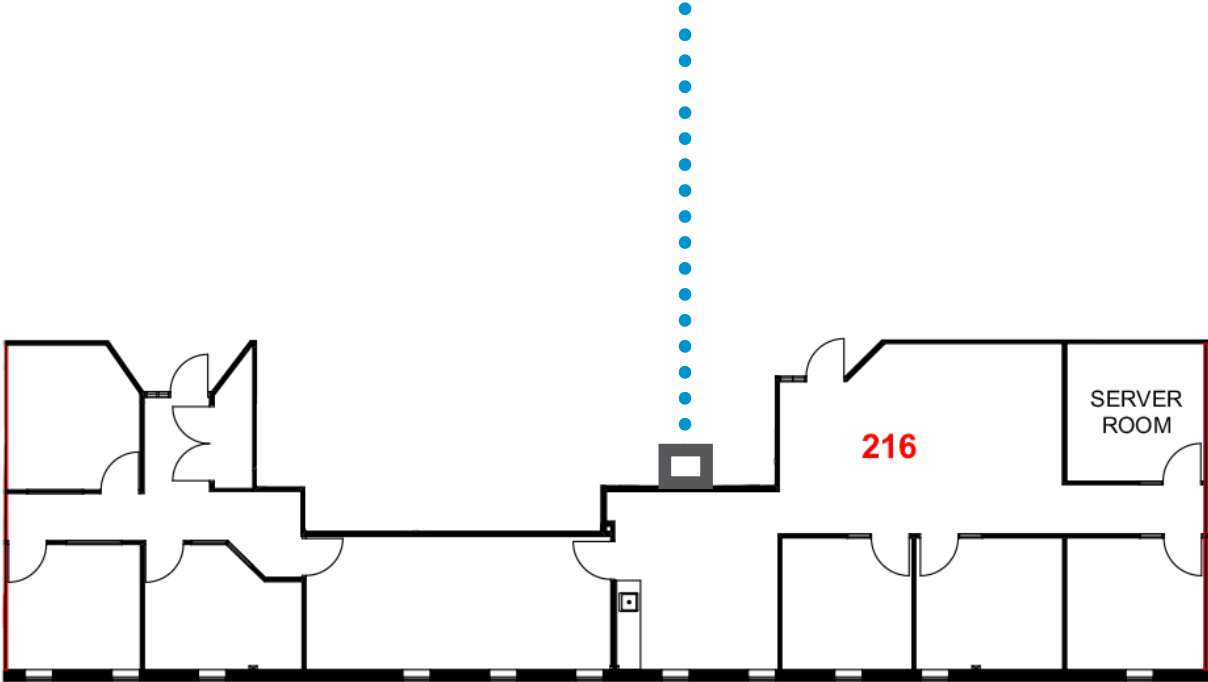
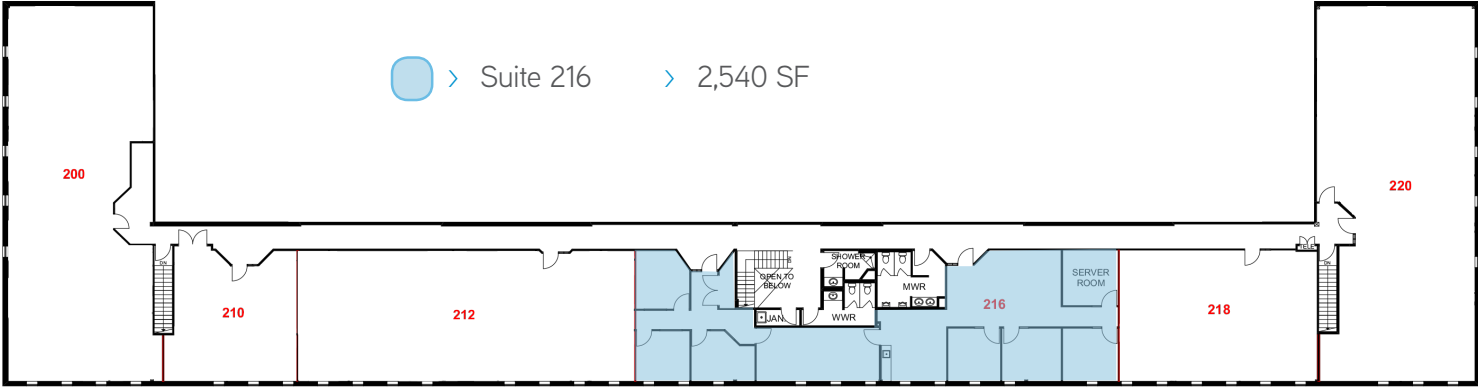

# 1140 MORRISON DRIVE

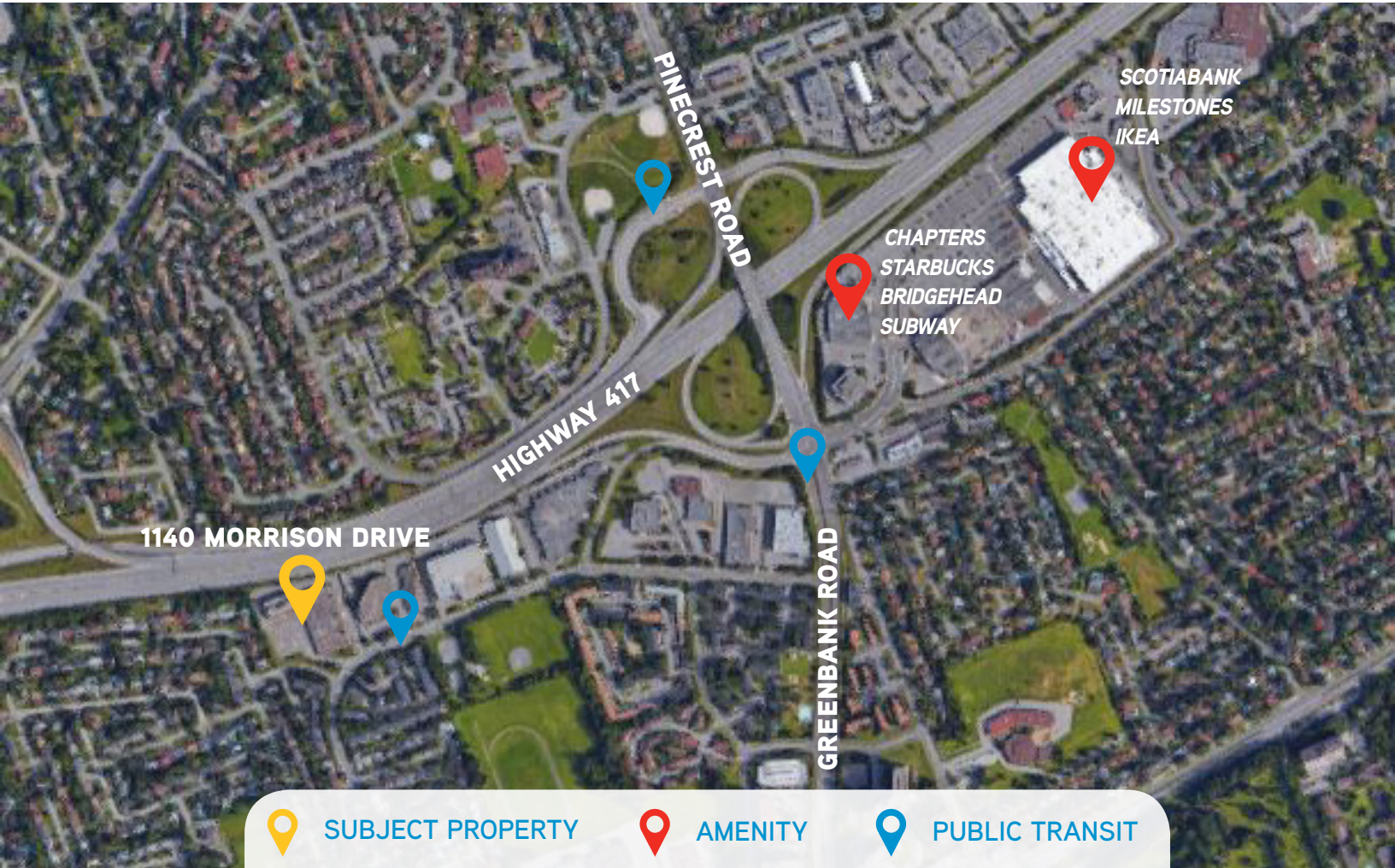

## CONTACT US



**SARAH AL-HAKKAK**  
Sales Representative  
+1 613 683 2212  
sarah.alhakkak@colliers.com

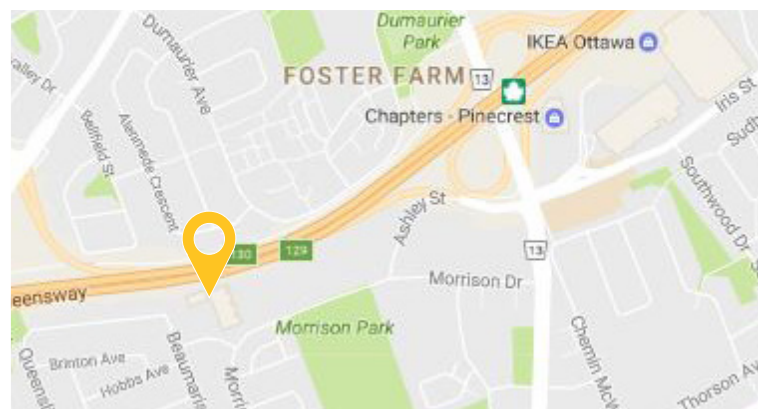

[collierscanada.com](http://collierscanada.com)

This document/email has been prepared by Colliers International for advertising and general information only. Colliers International makes no guarantees, representations or warranties of any kind, expressed or implied, regarding the information including, but not limited to, warranties of content, accuracy and reliability. Any interested party should undertake their own inquiries as to the accuracy of the information. Colliers International excludes unequivocally all inferred or implied terms, conditions and warranties arising out of this document and excludes all liability for loss and damages arising there from. This publication is the copyrighted property of Colliers International and /or its licensor(s). © 2017. All rights reserved. This communication is not intended to cause or induce breach of an existing listing agreement. Colliers Macaulay Nicolls Inc.

