

[www.galaxycentre.ca](http://www.galaxycentre.ca)



2 Storey Offices

# Galaxy Airport Centre

165 Galaxy Blvd & 175 Galaxy Blvd, Toronto

## OFFICE SPACE AVAILABLE



Developed by



Listed by





## SPECIFICATIONS

### 165 GALAXY BLVD

#### Site Overview

Overlooking Mimico Creek and Royal Woodbine Golf Club, Galaxy Airport Centre is ideally situated only minutes from Toronto Pearson International Airport with easy access to all major 400 series highways.

**ONE UNIT AVAILABLE**

**APPROXIMATELY 3,873 SF  
REMAINING**

- › New Construction
- › Building Size: 68,200 sf (3,873 sf Available)
- › Two Storey Configuration
- › Low Gross-up Factor: Ground Floor  
Approximately 3,873 sf Available)
- › Parking: 3.7 per 1,000 sf Leased
- › LEED Silver Certification, Green ROOF Design
- › Net Rent: \$ 20.75 psf per annum (Years 1-5)  
\$ 21.50 psf per annum (Years 5-10)
- › T&O: \$10.43 psf per annum (2019 Estimate)
- › Common Area Utilities Included (In-Suite Hydro Additional)
- › In-Suite Janitorial Included
- › Lease Term: 5 to 10 Years
- › Tenant Improvement Allowance: \$50.00 psf







## FLOOR PLANS - 165 GALAXY BLVD

GROUND FLOOR

APPROXIMATELY 3,873 SF  
REMAINING

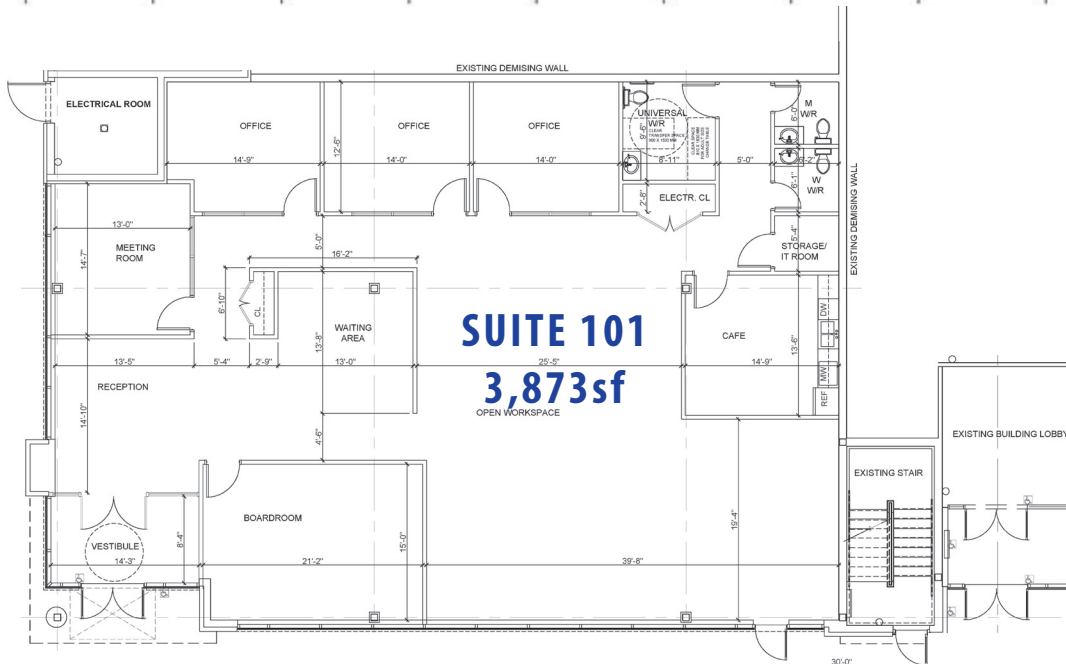

## SITE PLAN

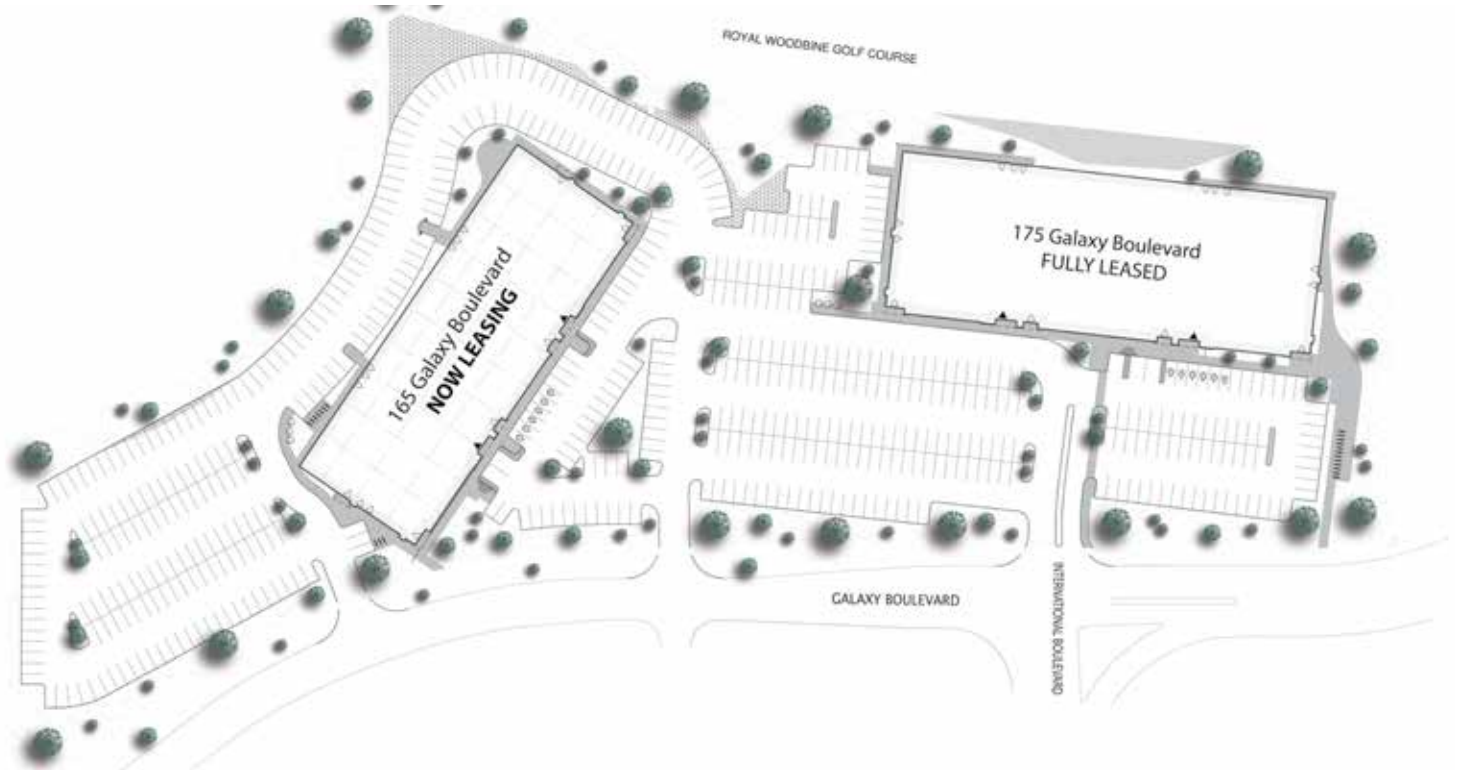





## AMENITIES MAP

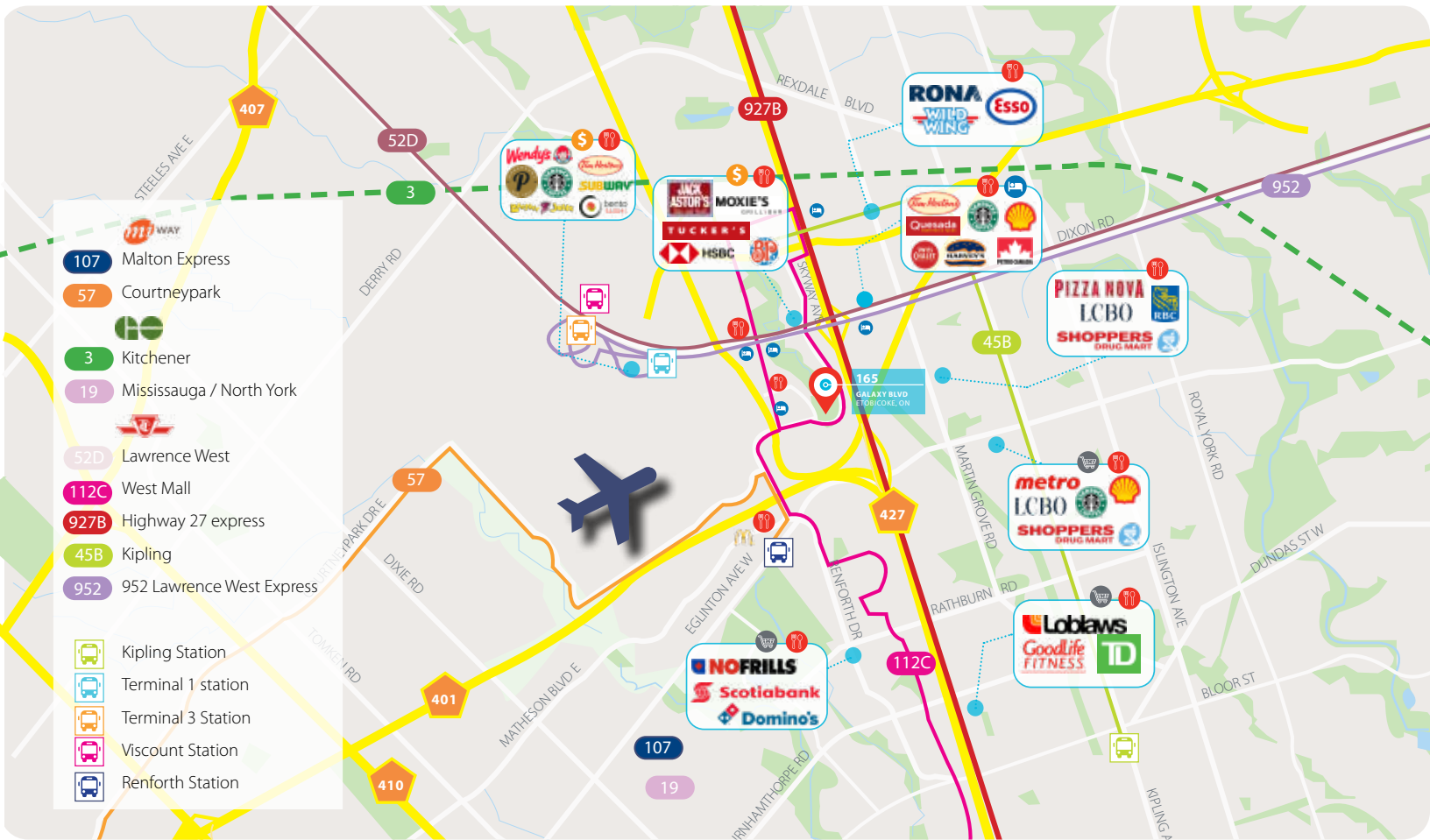

## NUMBER OF AMENITIES WITHIN 5 KM



FOR LEASE | 165 & 175 Galaxy Boulevard, Toronto | [galaxycentre.ca](http://galaxycentre.ca)

## SAMPLE INTERIOR PHOTOS





[www.galaxycentre.ca](http://www.galaxycentre.ca)

For more information, please contact:

- › Jeff Flemington, <sup>CCIM, SIOR, LEED AP</sup>  
Broker  
[jeff.flemington@avisonyoung.com](mailto:jeff.flemington@avisonyoung.com)  
905.283.2336
  
- › Kurt Love, <sup>SIOR</sup>  
Sales Representative  
[kurt.love@avisonyoung.com](mailto:kurt.love@avisonyoung.com)  
905.283.2341

Avison Young is the real estate partner businesses trust for intelligent, integrated solutions. We deliver results that are aligned with your strategic business objectives, supporting real estate initiatives that add value and build competitive advantage for your organization.



Avison Young  
Commercial Real Estate (Ontario) Inc., Brokerage  
77 City Centre Drive, Suite 301 Mississauga, Ontario, Canada L5B 1M5  
T 905.712.2100 F 905.712.2937 [avisonyoung.com](http://avisonyoung.com)

Located in the City of Vaughan within the Greater Toronto Area, the Gottardo Group of Companies is a real estate developer, design builder, and general contractor that serves clients throughout South Western Ontario. Successful completion of prestigious developments, office buildings, industrial distribution and manufacturing facilities, retail centres, and specialty use buildings has established the company as a leader in the construction sector.



Gottardo Group of Companies  
277 Pennsylvania Avenue  
Concord, Ontario, Canada L4K 5R9  
T 905.761.7707 F 905.761.6588 [gottardogroup.com](http://gottardogroup.com)